



EVOGUARD

# ESL Valve Series

For beverages with extended product shelf life



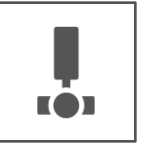

## A sure thing for sensitive beverages

High level of hygiene without the use of aseptic valve technology - that's a mandatory programme for many applications in beverage manufacturing. With the new EVOGUARD ESL valve series, beverage manufacturers are now provided with seat and double-seat valves with a hygienic design for reliable processes for the production of sensitive products.

The high efficiency of these valves is based on the low costs compared to aseptic valve technology and on the high number of switching cycles achievable.

### At a glance

- Design of the valve series in hygiene class IV
- Application range for sensitive soft drinks without preservatives and beverages sold within the cold chain
- Newly developed sealing system for optimum cleaning conditions



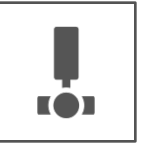

## Design Characteristics of EVOGUARD ESL Valves

### Valve housing

- Modular system for various designs of the seat and double-seat valves, nominal diameters DN 40 to DN 125
- Operating temperature up to 150 °C
- Valve housing without dome, designed for PN 25
- Newly developed sealing system instead of a shaft seal with defined pressing of the sealing point
- Material of sealing element: PTFE compound
- Free valve cross-sections
- Certification of optimum cleaning conditions in accordance with the requirements specifications of the EHEDG - currently being tested
- Final design subject to internal approval

### Drive

- Maintenance-free actuator for 1,000,000 switching cycles
- Actuator arrangement according to product pressure of 6 bar or 10 bar

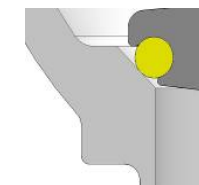
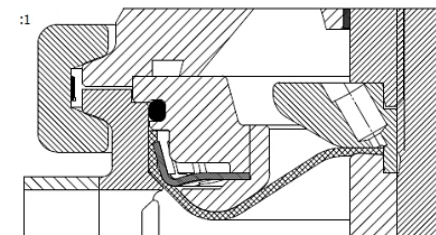

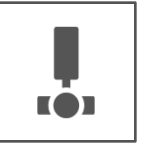

## Design Characteristics of EVOGUARD ESL Valves

### EVOGUARD ESL Seat Valve

Used for shutting off pipe systems in ESL processes

- Resistant to all products and cleaning agents
- Large range of variants for integration in all pipe routing layouts

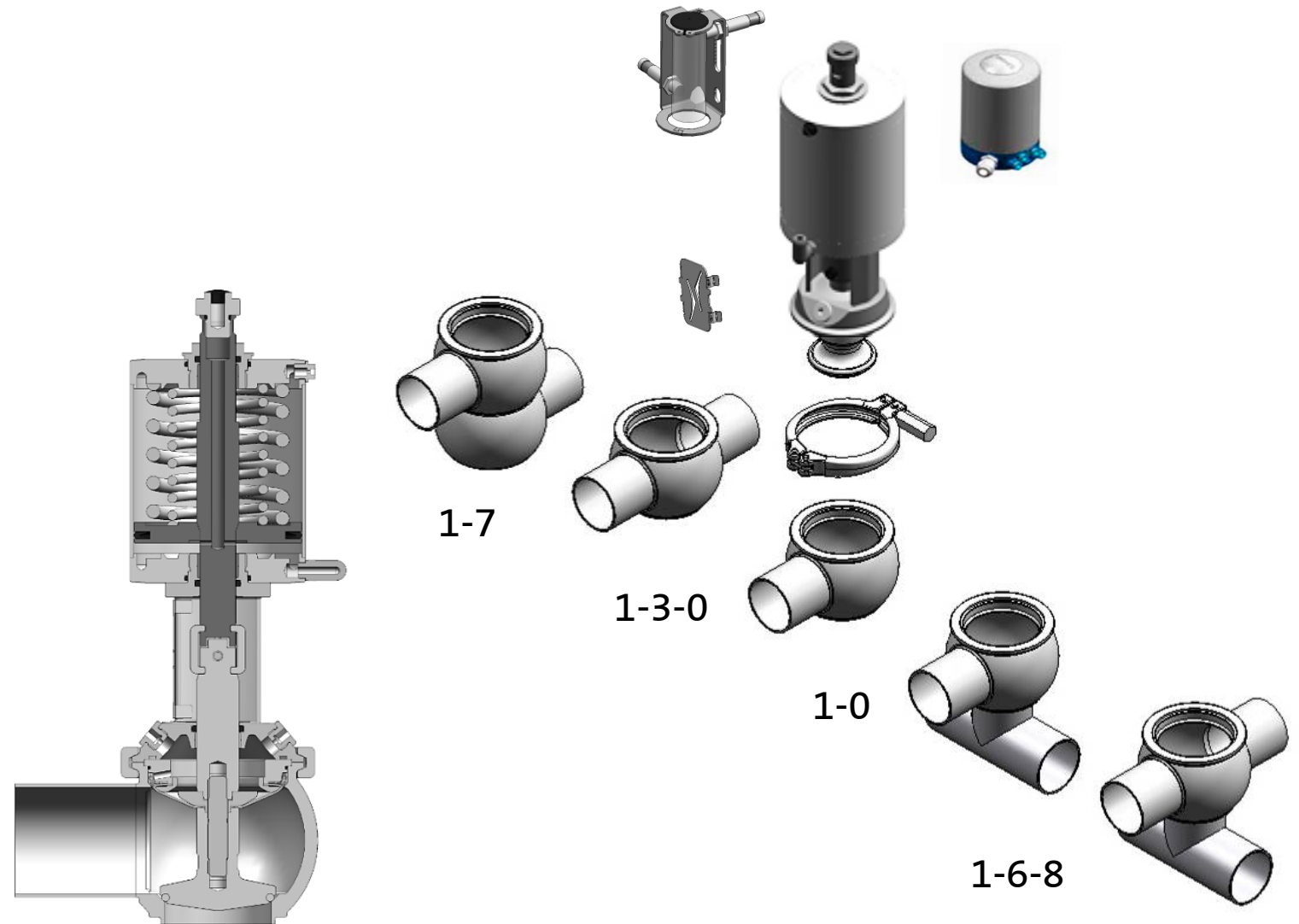



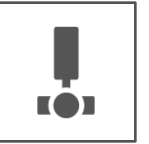

## Design Characteristics of EVOGUARD ESL Valves

### EVOGUARD ESL Double Seat Mixproof Valve

Used for separating incompatible media in ESL processes

- Cleaning of leakage space with flushing valves or operating the top and bottom valve disk at intervals
- Angled infeed valve
- Connections for leakage discharge and/or for monitoring of bellows
- Actuator with integrated timing functions

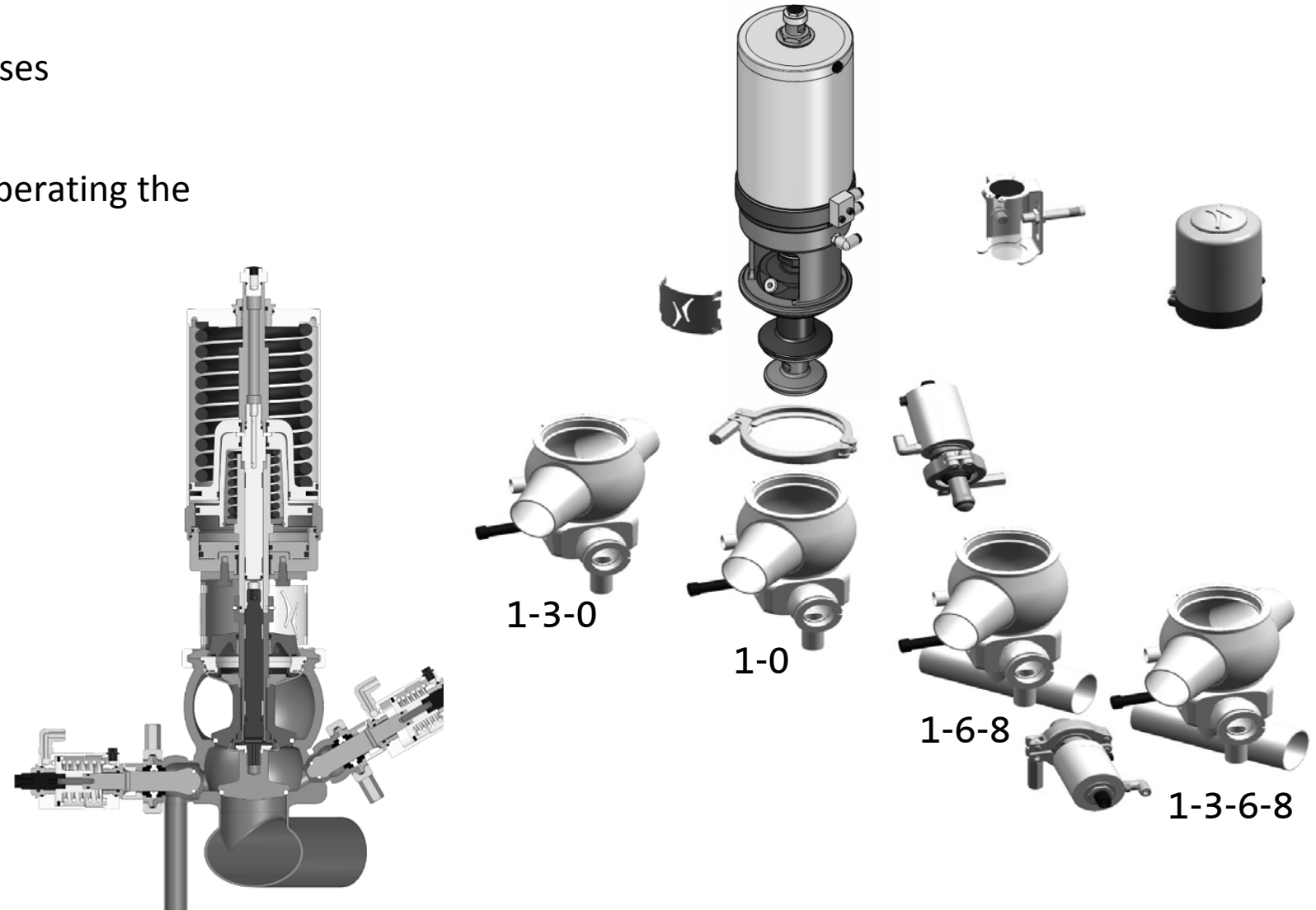

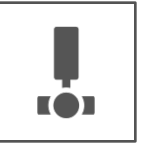

## Your benefits in figures

- Valve series in hygiene class IV for processing sensitive beverages
- 500,000 switching cycles possible without seal replacement
- Solution 20 percent less expensive compared with the use of aseptic valves



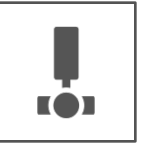

## Benefits to you

### High level of hygiene in economic design

The design without a dome and the newly conceived seal on the valve shaft guarantee hygienic system conditions - even without aseptic valve technology.

### High resistance

The seal material is highly resistant to all products and cleaning agents.

### High performance

The seal is designed for 500,000 switching cycles and the drive for 1,000,000 cycles - the basis for high performance of the components.

### Independently tested

With the test methods currently carried out for certification of the valves in accordance with the requirements specifications of the EHEDG TYPE EL CLASS I, we document that the highest hygienic conditions are complied with in the process.



## Everything from a single source

### **KIC KRONES cleaning agents make your machine shine**

Only if the production environment is immaculate, can your product be brilliant. KIC KRONES provides you with the optimum cleaning agents and disinfectants for each individual production step.

### **Lubricants from KIC KRONES for every production step**

Whether for gears, chains or central lubrication systems – our greases and oils are true all-round talents. They can reach every lubrication point, protect your line and ensure gentle treatment for your products thanks to their food-grade quality.

### **EVOGUARD – pumps for absolute process safety**

In addition to the separation and locking of a line, one thing is particularly important - and that is the reliable conveyance of your product. This is why EVOGUARD also offers innovative centrifugal pumps in addition to high-quality valves.





